

BLOW-UP
N.T.S.

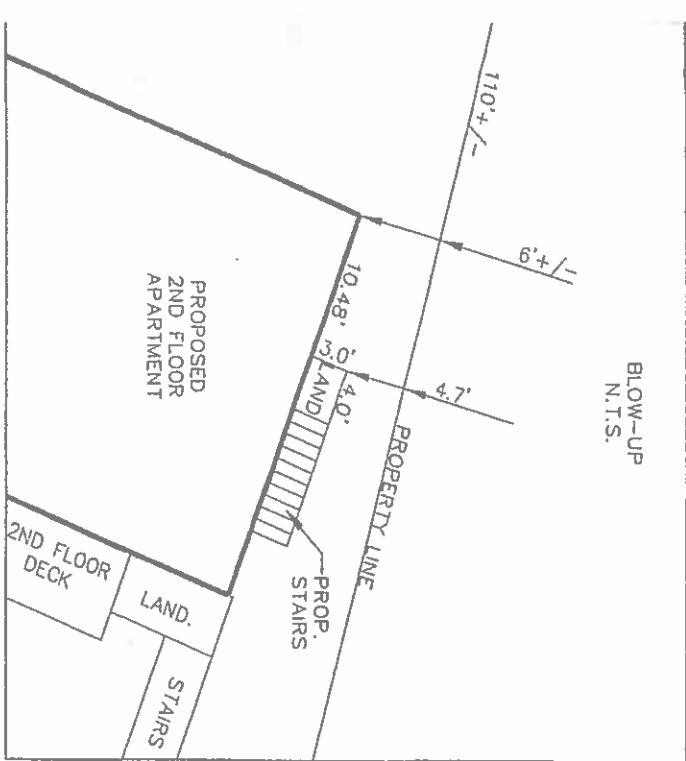

N/F ROBERT SAPIORETTI
MAP 26 PARCEL 11

N/F RAYMOND PELLETIER
MAP 26 PARCEL 10



LOT B
N/F ANTHONY MINUCCI

POND STREET
(ROUTE 126)

N/F S & G REALTY TRUST
MAP 26 PARCEL 247

N/F ANTHONY MINUCCI
MAP 26 PARCEL 241
LOT 14-B-4

N/F JAMES NEIL WIKEN
MAP 26 PARCEL 245

CONC. RET. WALL
UNKNOWN
EDGE OF BORDERING
VEGETATED WETLANDS
#B-8
#B-9

I CERTIFY THAT THE BUILDINGS ARE
LOCATED ON THE LOT AS SHOWN



- NOTES:
1. SEE DEED BOOK 68964 PAGE 41
 2. SEE PLAN NO. 1035 OF 1992
 3. SEE PLAN NO. 224 OF 1945
 4. PARKING SPACES NUMBERED 3 & 4 ARE 9' X 18'
 5. EXISTING WATER AND SEWER INFO PROVIDED BY DPW DEPT
 6. THERE ARE NO WETLANDS ON THIS PROPERTY.
 7. WETLAND FLAGS ADJACENT TO POND STREET ARE EXISTING AND ARE DELINEATED BY OTHERS. FIELD LOCATED BY THIS OFFICE
 9. PROPERTY LINES ARE COMPILED FROM RECORD PLAN, PLAN NO. 224 OF 1945

ZONE DISTRICT "CH" HIGHWAY COMMERCIAL	REQUIRED	EXISTING
AREA	30,000 S.F.	11,010 S.F. +/-
150' FRONTAGE		100.0'
30' FRONT		48' +/-
10' SIDE		6' STRUCTURE
30' REAR		3' LANDING
		31' +/-

CERTIFIED PLOT PLAN

IN
ASHLAND, MASSACHUSETTS
PREPARED FOR: KLEIDIANE TORRES
SCALE: 1"=20' DATE: JULY 23, 2018
PREPARED BY: J.D. MARQUEDANT & ASSOCIATES INC.
LAND SURVEYING
6 WALCOTT STREET HOPKINTON, MA. 01748

REVISIONS:

NO.	DATE	DESCRIPTION
1	10/15/18	
2	11/8/18	
3	11/13/18	