

POND STREET
(ROUTE 126)

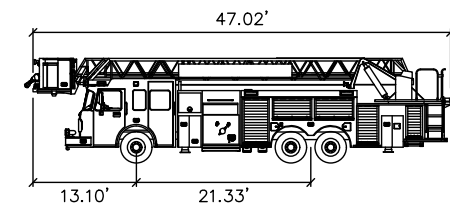

Ashland Tower 1 – HME 104' RMA
 Width : 9.33 FT.
 Track : 8.50 FT.
 Lock to Lock Time : 6.0 SEC.
 Steering Angle : 33.2°

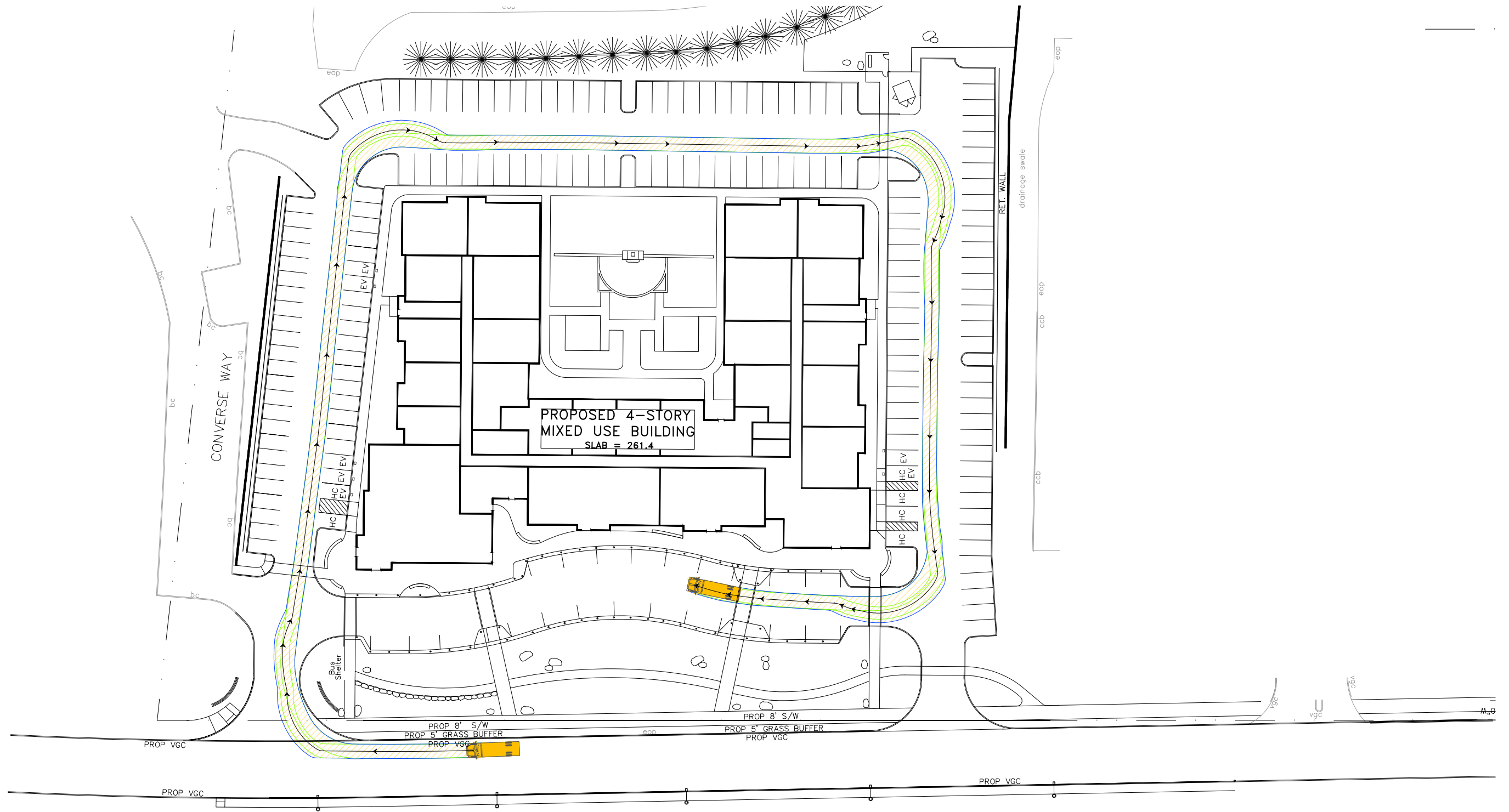
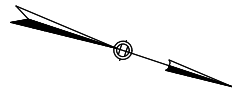

POND STREET
(ROUTE 126)

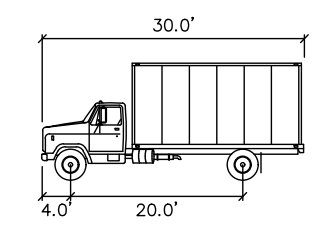

SU-30
 Width : 8.0 FT.
 Track : 8.0 FT.
 Lock to Lock Time : 6.0 SEC.
 Steering Angle : 31.8°

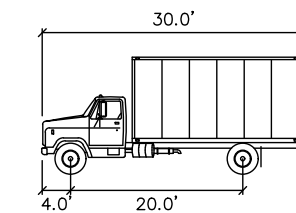
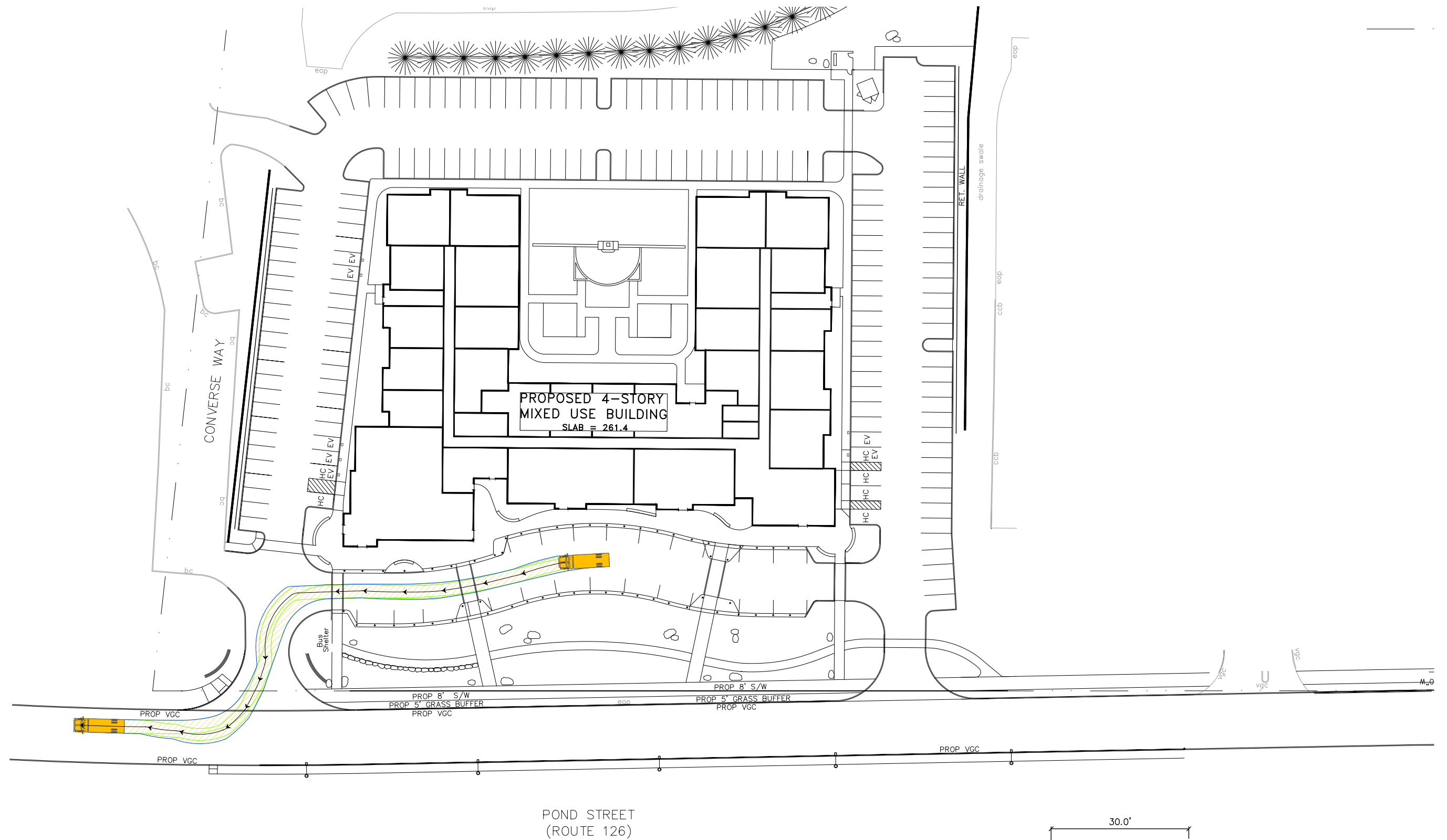
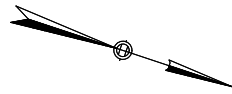

SU-30
 Width : 8.0 FT.
 Track : 8.0 FT.
 Lock to Lock Time : 6.0 SEC.
 Steering Angle : 31.8°

